

Copyright. All information furnished within this document, electronic file or design correspondence is the property of Den Hartog industries, Inc. and shall not be used, disclosed to others or copied without the expressed written consent of Den Hartog Industries, Inc.

SEE PRINT HE1250-BAF FOR BAFFLE INSTALLATION INSTRUCTIONS

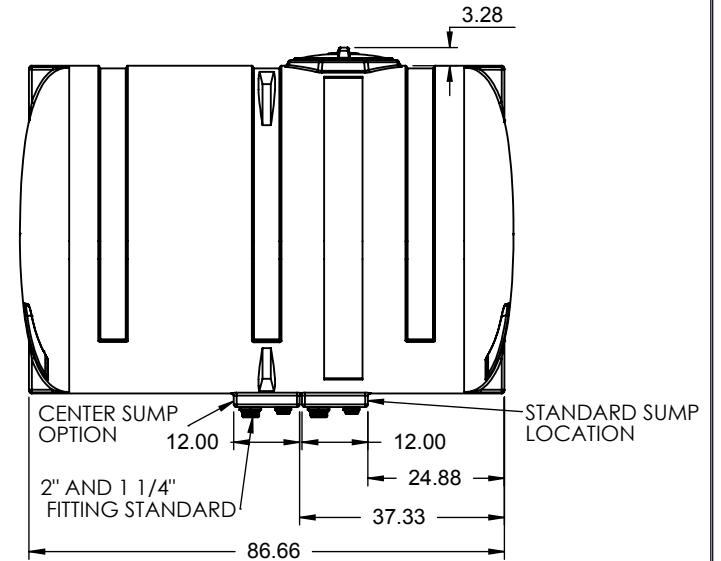

|     |   |                                      |     |                              |   |
|-----|---|--------------------------------------|-----|------------------------------|---|
|     |   |                                      |     | DRAWN / DATE<br>ADH 8/12/08  | MATERIAL<br>1.) POWDER, 3 MELT<br>(10420) |
|     |   |                                      |     | APPRD. / DATE<br>REH 8/14/08 |   |
| REV | DESCRIPTION   | BY / DATE                            | CCN | SHOT WEIGHT:<br>370LBS       | NOTES:<br>1.) 0.400 NOMINAL WALL          |
|     | ALL DIMENSIONS ARE IN DECIMAL INCHES<br>TOLERANCES UNLESS OTHERWISE SPECIFIED |                                      |     | SHIPPING WEIGHT:             |   |
|     | POLYETHYLENE<br>±1% @ 68°F  |                                      |     | FINISH:                      |   |
|     | METAL<br>DECIMAL ± .125"<br>FRACTION ± 1/4"<br>ANGLE ± 1°                     | THIRD ANGLE PROJECTION<br>ANSI 14.5M |     |                              |   |

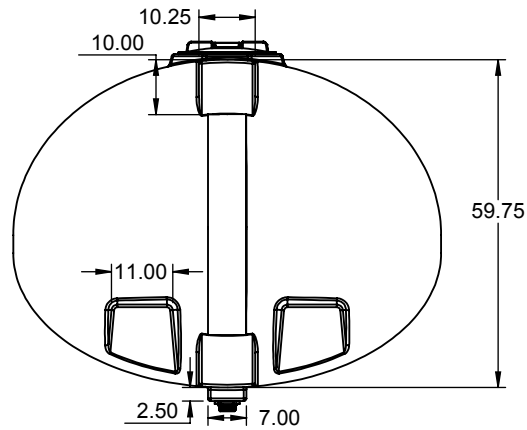
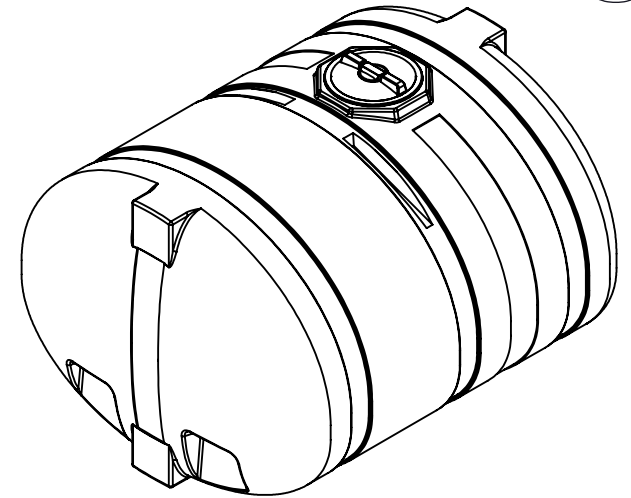
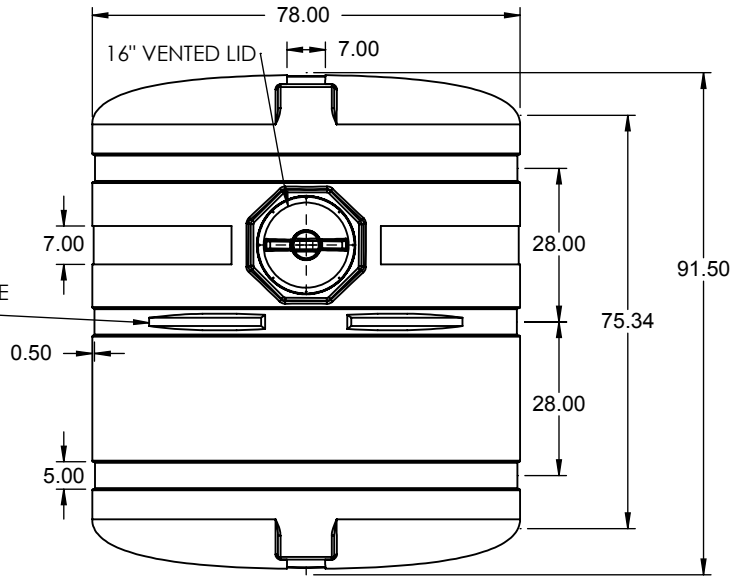

**Den Hartog**  
INDUSTRIES, INC.

Ace Roto-Mold Injection Molding Blow Molding Sowjoy

4010 HOSPERS DRIVE S. BOX 425, HOSPERS, IOWA 51238-0421

DESCRIPTION 1250 GALLON ELLIPTICAL TANK-SHALLOW SUMP

SCALE N.S.

PART NO. HE1250-78